

PROFESSIONAL'S SEAL:

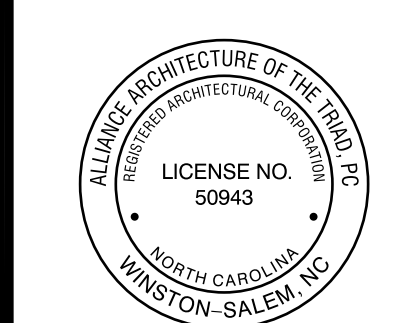

CORPORATE SEAL:



GENERAL NOTES:

- ANY DIMENSIONS THAT ARE SHOWN WHICH THE GENERAL CONTRACTOR FINDS TO BE INCONSISTENT WITH THE PLANS SHALL BE IMMEDIATELY BROUGHT TO THE ATTENTION OF THE FOOD LION CONSTRUCTION MANAGER.
- GENERAL CONTRACTOR TO INSTALL GUARD POST AS INDICATED ON SITE-SPECIFIC A1.01.
- PLAN SHOWS APPROXIMATE EXTENT OF SLAB REMOVAL. GENERAL CONTRACTOR SHALL COORDINATE W/CONSTRUCTION MANAGER AND REFRIGERATION CONTRACTOR FOR THE PHASING AND PORTIONS OF SLAB REMOVAL TO EXECUTE THE WORK.

UNDER SLAB

- GENERAL CONTRACTOR SHALL REFER TO SHEET P1.01 AND P1.02 FOR TRENCH DRAINS, HUB DRAINS AND REFRIGERATION LINE PIT LOCATIONS BEFORE POURING SLAB OR FOOTINGS
- GENERAL CONTRACTOR SHALL TAKE EXTRA PRECAUTION WHEN POURING CONCRETE SLABS SO AS NOT TO CRUSH REFRIGERATION AND SANITARY SEWER LINES. REFER TO SHEET P1.02 FOR LINE LOCATIONS.
- SOIL UNDER ALL NEW SLABS TO BE TREATED FOR TERMITES PER SPECIFICATIONS.
- GENERAL CONTRACTOR SHALL PROVIDE CUT OR SELECT FILL MATERIAL FOR SLABWORK. USE AGGREGATE NO LARGER THAN #57 FOR ALL NEW CONCRETE SLABS. SEE STRUCTURAL DRAWINGS FOR ADDITIONAL INFORMATION.

CONCRETE SLAB

- NO CONSTRUCTION OR CONTROL JOINTS SHALL BE INSTALLED IN PRODUCE PREP, GROCERY STAGING AREA AND DELI/BAKERY U.O.N.
- THE GENERAL CONTRACTOR SHALL USE 10 MIL UNDER SLAB VAPOR RETARDER TURNED UP AT CONCRETE SLAB EDGES AND 30 LB FELT AROUND ALL INTERIOR COLUMNS. NO EXPANSION JOINT MATERIAL SHALL BE USED.
- THE GENERAL CONTRACTOR SHALL PROVIDE LABOR AND MATERIALS TO FILL SPECIFIED FLOOR DEPRESSIONS AND PITS TO SPECIFIED HEIGHTS.
- THE GENERAL CONTRACTOR SHALL VERIFY CONDITION OF EXISTING CONCRETE SLABS. AREAS THAT ARE NOT SPECIFICALLY ADDRESSED ON THE DRAWINGS OR IN THE BID NOTES SHALL BE BID SEPARATELY. COORDINATE WITH FOOD LION CONSTRUCTION MANAGER. GENERAL CONTRACTOR SHALL INCLUDE FLOOR PATCHING OR LEVELING TO BE DONE BECAUSE OF RELOCATION OF FLOOR STUBS, FIXTURES, PLUMBING & ELECTRICAL WORK.
- IF APPLICABLE: TEMPERATURE DRAW-DOWN PROCEDURE SHALL NOT BEGIN PRIOR TO COMPLETE CONCRETE CURING (MINIMUM OF 30 DAYS AFTER INSTALLATION). ALL STORES WITH INSULATED CONCRETE FLOORS IN FREEZERS MUST BE SLOWLY BROUGHT DOWN TO TEMPERATURE FOLLOWING THE SCHEDULE BELOW TO PREVENT CRACKING THE FLOOR DUE TO THERMAL CONTRACTION. CAULKING OF SLAB-WALL JOINTS AND EXPANSION JOINTS SHOULD BE DONE AFTER THE RECOMMENDED 35 DEGREE HOLD PERIOD.

TEMPERATURE	TIME
AMBIENT TO 35° F	10' PER EVERY 24 HOURS
HOLD AT 35° F	3-5 DAYS
35° F TO FINAL TEMP	10' PER EVERY 24 HOURS

FLOOR SLOPES

- THE FLOOR SLAB SHALL SLOPE 1/16" PER FOOT TO DRAINS IN ALL AREAS WHERE FLOOR DRAINS OCCUR. SLOPES WILL CORRESPOND WITH PLUMBING WORK, SEE P1.01 AND P4.01.
- GENERAL CONTRACTOR SHALL PROVIDE POSITIVE DRAINAGE IN ALL PREP AREAS, RESTROOMS, AND COOLERS.
- THIS SLAB AREA TO BE FLAT (NOT SLOPED) AND LEVEL WITH FINISHED FLOOR.

CONCRETE FINISH

- THE GENERAL CONTRACTOR SHALL CAULK ALL JOINTS AT JUNCTURE OF SLABS AND WALLS WITH URETHANE SEALANT (GRAY), INCLUDING AREAS BEHIND CASES AND ALL OTHER AREAS THAT ARE NOT EXPOSED. THIS SHALL BE DONE PRIOR TO APPLYING FINISHES.
- ALL NEW EXPOSED CONCRETE SLABS SHALL NOT RECEIVE AN APPLICATION OF SHAKE-ON HARDENER, BUT RATHER LIQUID DENSIFIER/SEALER. LIQUID DENSIFIER/SEALER SHALL BE "EUCO DIAMOND HARD" BY THE EUCO CHEMICAL COMPANY. RATE OF APPLICATION SHALL BE PER SPECIFICATIONS. ALL NEW UNEXPOSED CONCRETE SLABS: AREAS RECEIVING VCT, HARD TILE OR RESINOUS FLOORING DO NOT REQUIRE LIQUID DENSIFIER/SEALER.

TRENCH WORK

- FIBERGLASS PITS CAN BE MODIFIED AS NEEDED TO WORK AROUND EXISTING CONDUIT, ETC. POUR-BACKS SHALL BE FINISHED FLUSH WITH A MINIMUM 2" CONCRETE TO THE EXISTING SLAB; ALLOW FOR FUTURE PIT ACCESS. ALL REVISED PITS MUST BE SEALED COMPLETELY TO RODENT-PROOF AND ELIMINATE CONSTRUCTION MATERIAL FROM DAMAGING THE REFRIGERATION LINES. SPECIAL PRECAUTIONS NEED TO BE MADE WHEN CUTTING HOLES IN FIBERGLASS BOXES; LIMIT THE AMOUNT OF FIBERGLASS THAT IS CUT AWAY FOR LINE INSTALLATIONS. ALL NEW PITS SHALL BE FIBERGLASS! ALL PITS SHALL BE PHOTOGRAPHED WITH CURRENT DATE TO SHOW INTERIOR "BEFORE AND AFTER" VAPOR RETARDER INSTALL AND TRENCH COMPLETION.
- ALL DIRT SHALL BE REMOVED FROM THE STORE WITH ABSOLUTELY NO SPILLAGE ONTO THE EXISTING FLOOR. TRENCHES SHALL BE BACKFILLED WITH AGGREGATE NO LARGER THAN #57, DOWELS IN CONCRETE AND PROPER VAPOR BARRIER. OPEN TRENCHES ARE TO BE COVERED WITH 1/2" MIN. METAL PLATE AND MATCHING CARPET MATS, AND DUCT TAPED TO THE FLOOR. DURING OPERATING HOURS, ALL PITS SHOULD BE PHOTOGRAPHED WITH A CURRENT DATE TO SHOW INTERIOR BEFORE AND AFTER VAPOR RETARDER INSTALL AND TRENCH COMPLETION.
- CARPET MATS ARE TO BE CLEAN, SAME IN COLOR, AND HAVE RUBBER EDGES. ALL MATS ARE TO BE TAPED IN PLACE AT ALL TIMES.

WALLS

- IF APPLICABLE: NEW WALLS AT RECEIVING DOCK, RAISED PLATFORMS AND RAMPS TO BE FILLED SOLID WITH CONCRETE.

SLAB LEGEND

	NEW CONCRETE SLAB AND FILLED DEPRESSIONS
	SAW JOINT
	ABANDONED PITS
	EXISTING WALL
	NEW MASONRY REINFORCED WALL
	NEW GUARD POST & FOOTING
	EXISTING GUARD POST
	EXISTING COLUMN
	STEP IN SLAB
	QUARRY TILE & SETTING BED TO BE REMOVED

NOTES:

- DIMENSIONS PROVIDED ARE APPROXIMATE LIMITS OF SLAB REPLACEMENT WHERE NEW UNDER SLAB UTILITIES ARE BEING PROVIDED. COORDINATE WITH APPROPRIATE TRADE AND FOOD LION CONSTRUCTION MANAGER, TYPICAL.
- SLAB DIMENSIONS ARE TAKEN FROM INTERIOR SURFACES OF THE CLOSEST EXISTING WALL OR CLOSEST EXISTING COLUMN GRID LINE UNLESS OTHERWISE NOTED.
- DIMENSIONS OF SLAB CUTS ARE 2'-0" WIDE UNLESS OTHERWISE NOTED, TYPICAL.
- PLAN SHOWS APPROXIMATE EXTENTS OF SLAB REMOVAL. GENERAL CONTRACTOR SHALL COORDINATE W/ FOOD LION CONSTRUCTION MANAGER AND REFRIGERATION CONTRACTOR FOR PHASING AND PORTIONS OF SLAB REMOVAL TO EXECUTE WORK, TYP.
- GENERAL CONTRACTOR SHALL PATCH AND REPAIR FLOOR, CEILING, ADJOINING WALLS AND OPENINGS WHERE WALLS, DOORS & FRAMES AND EQUIPMENT HAVE BEEN REMOVED. WORK WILL BE DONE IN A PROFESSIONAL MANNER WITH MATCHING MATERIALS.

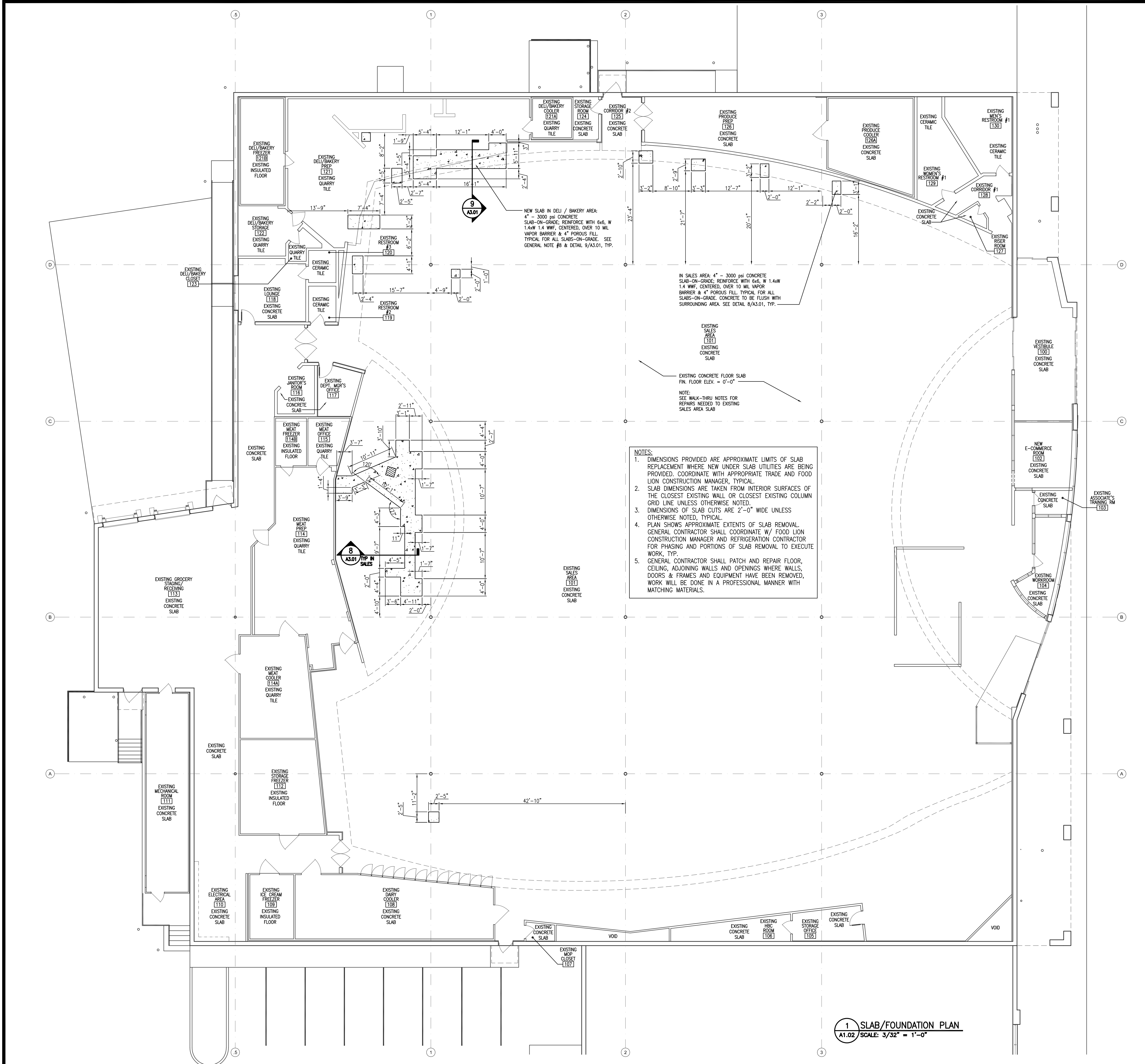

1 SLAB/FOUNDATION PLAN
 A1.02 SCALE: 3/32" = 1'-0"

REVISIONS

NO	DATE	REMARKS
1	00/00/00	COMMENTS

END

FOOD LION
 2110 Executive Drive, Salisbury, NC 28145
 Phone: 703.636.6200
 foodlion.com
 Food Lion is an AHOLD DELHAIZE company.

FOOD LION REMODEL STORE #1657
 4330 E. TENTH STREET
 GREENVILLE, NC

PROJECT NO: 1657FLMK22
 DATE: 08/29/2022
 07 OF 40
A1.02
 SLAB/FOUNDATION PLAN
 CHECKED: AJL DRAWN: VFS