

PROFESSIONAL'S SEAL:

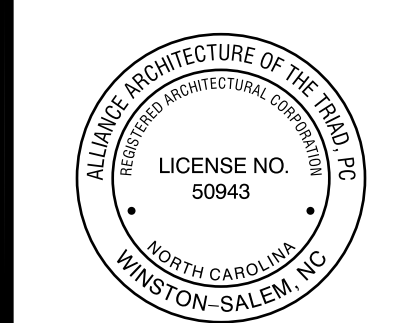

CORPORATE SEAL:



REVISIONS
 NO DATE REMARKS



FOOD LION REMODEL STORE #1657
 4330 E. TENTH STREET
 GREENVILLE, NC

PROJECT NO: 1657FLMK22
 DATE: 08/29/2022
 10 OF 40
A1.05
 FLOOR FINISH PLAN

CHECKED: A.J.L. DRAWN: V.P.S.

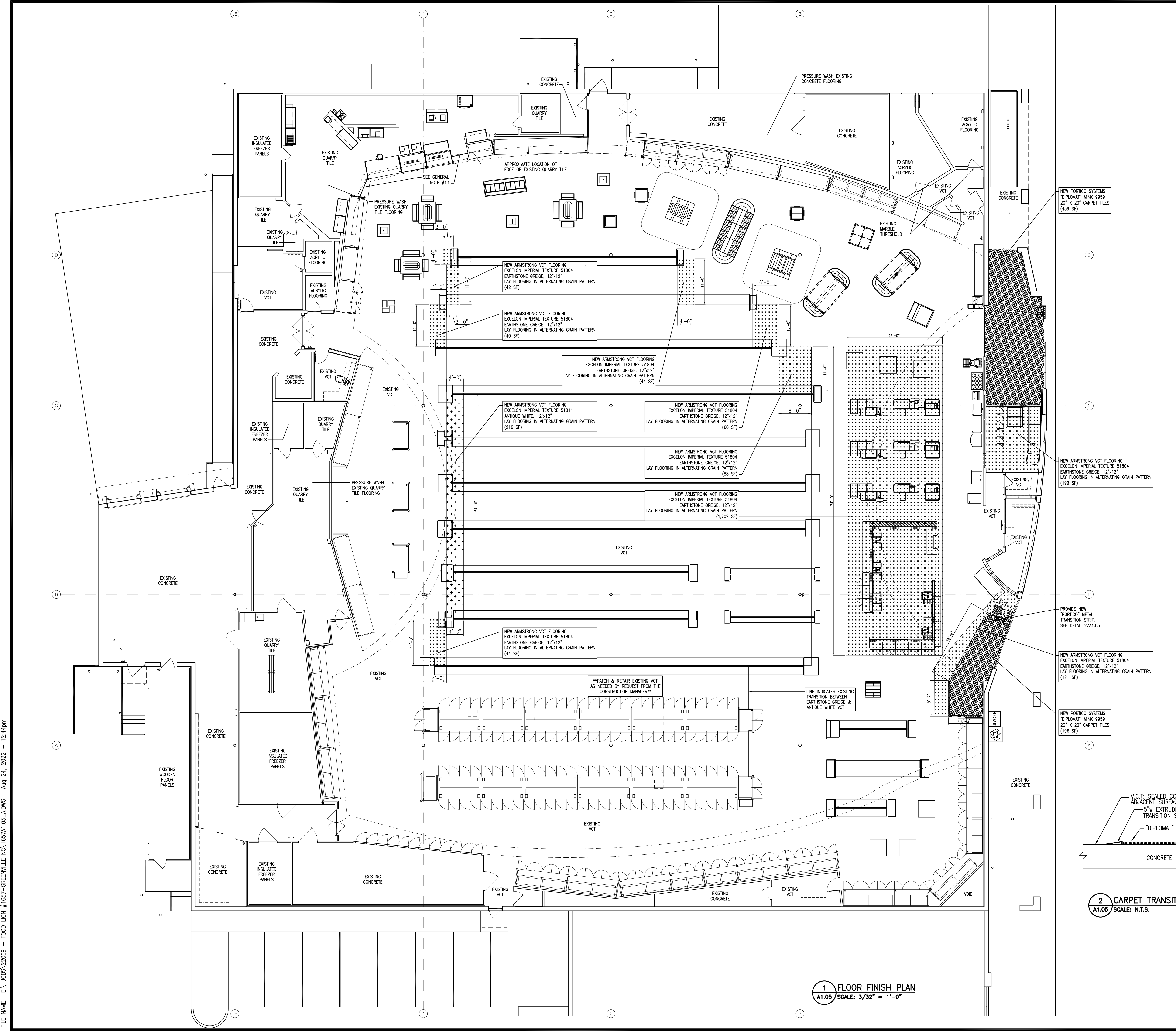

- GENERAL FLOORING NOTES:**
1. VINYL FLOOR TILE (VCT). SEE SPECIFICATIONS FOR ACCEPTABLE ADHESIVE FOR VINYL COMPOSITION TILE (VCT).
 2. THE VINYL COMPOSITION TILE SHALL BE 1/8" MANUFACTURED BY ARMSTRONG.
 3. THE GENERAL CONTRACTOR SHALL FURNISH AN ADDITIONAL 8% OF EACH COLOR OF VCT TO BE LEFT AT THE STORE. COORDINATE WITH THE FOOD LION CONSTRUCTION MANAGER.
 4. THE GENERAL CONTRACTOR SHALL THOROUGHLY CLEAN AND WAX (2 COATS MINIMUM) VCT IMMEDIATELY AFTER INSTALLATION. ONLY USE CLEANER AND WAX PRODUCTS RECOMMENDED BY THE FLOOR MANUFACTURER.
 5. THE FLOORING INSTALLER SHALL PERFORM A CALCIUM CHLORIDE OR HUMIDITY TEST FOR EACH 1,000 SQUARE FOOT AREA WHERE FLOORING WILL BE INSTALLED. THE INSTALLER SHALL PROVIDE A REPORT TO THE FOOD LION CONSTRUCTION REPRESENTATIVE FOR ALL AREAS THAT MOISTURE FALLS ABOVE 5 POUNDS, AND PROVIDE AN APPROPRIATE DAMP PROOF MEMBRANE.
 6. THE GENERAL CONTRACTOR SHALL ALTERNATE THE FIELD TILES.
 7. CARPET/MAT TILE. ENTRANCE FLOOR TILE SHALL BE "DIPLOMAT" BY PORTICO SYSTEMS WITH TAC FAST BACKING. COLOR SHALL BE "MINK" 9959. DIPLOMAT SHALL BE INSTALLED BY PORTICO SYSTEMS. CONTACT GREG GRIFFIN (864) 527-3148. THE GENERAL CONTRACTOR SHALL FURNISH 5% EXTRA OF THE TOTAL AMOUNT OF DIPLOMAT USED. TO BE LEFT IN THE BACK ROOM OF THE STORE FOR FUTURE USE.
 8. PHARMACY CARPET, WHEN APPLICABLE, SHALL BE "DIPLOMAT" BY PORTICO SYSTEMS WITH TAC-FAST BACKING. COLOR SHALL BE "MINK" DIPLOMAT SHALL BE INSTALLED BY PORTICO SYSTEMS. CONTACT GREG GRIFFIN (864) 527-3148. THE GENERAL CONTRACTOR SHALL FURNISH 5% EXTRA OF THE TOTAL AMOUNT OF DIPLOMAT USED. TO BE LEFT IN THE BACK ROOM OF THE STORE FOR FUTURE USE.
 9. ALL PRODUCTS FOR UNDERLAYMENT OF VCT SHALL BE MAPEI TO PROVIDE A COMPLETE MAPEI SYSTEM. SEE SPECIFICATIONS.
 10. IN AREAS WHERE FLOOR DRAINS OCCUR, THE FINISH FLOOR SHALL SLOPE 1/16" PER FOOT TO DRAIN.
 11. SEAL ALL EXPOSED CONCRETE FLOORS WITH AN EXTRA COAT OF CONCRETE SEALER ONE WEEK PRIOR TO GROCERY DELIVERY. SEALER TO BE PER SPECIFICATIONS. COORDINATE WITH FOOD LION CONSTRUCTION MANAGER.
 12. THE GENERAL CONTRACTOR SHALL USE 10 MIL VAPOR RETARDER AT CONCRETE SLAB EDGES AND 30 LB. FELT AROUND INTERIOR COLUMNS. NO EXPANSION JOINT MATERIAL SHALL BE USED.
 13. THE GENERAL CONTRACTOR SHALL INSTALL A 4" WIDE 110A (1/8" THICK) STAINLESS STEEL THRESHOLD WITH COUNTERSUNK SCREWS AND SET IN A FULL BED OF SILICONE TO THE FLOOR FOR RESILIENT FLOOR FINISHES (RESINOUS FLOOR AND CONCRETE, VCT AND CONCRETE, RESINOUS FLOOR AND VCT, QUARRY TILE & VCT). GC SHALL INSTALL A BEVELED ADA COMPLIANT MARBLE THRESHOLD AT RESTROOM DOORS (4" WIDE x 5/8" HIGH).
 14. EXTERIOR SURECRETE APPLICATION SHALL BE SURECRETE DESIGN PRODUCTS "SURESPRAY" FIBERLE TEXTURE. COLOR "FL100". GC SHALL SEAL WITH SUREDECK SOLVENT-BASED OR SURSEAL WATER-BASED PROMOTED SEALER.
 15. RESINOUS DECORATIVE FLOORING. RESINOUS FLOORING TO TAPER OFF FLUSH WITH CONCRETE BEHIND COOLER PANEL. DO NOT INSTALL A METAL TRANSITION STRIP.
 16. RESINOUS DECORATIVE FLOORING SHALL BE PURCHASED FROM DUR-A-FLEX INC. CONTACT KEVIN STEPHENS AT (919) 208-8662 OR FROM PROTECTIVE INDUSTRIAL POLYMERS, CONTACT STEVE MCCAMEY AT (804) 937-5000.
 17. COORDINATE RESINOUS FLOOR LAYOUT WITH CASE INSTALLER.
 18. QUARRY/CERAMIC/PORCELAIN TILE. THE GENERAL CONTRACTOR SHALL CLEAN ALL EXISTING TILE IN THE RESTROOMS, MEAT PREP, MEAT COOLER, MEAT STORAGE, DELI/BAKERY PREP, DELI/BAKERY COOLER AND DELI/BAKERY STORAGE. ANY REPAIR OR REMOVALS TO BE DONE WITH MATCHING MATERIALS. COORDINATE ALL WORK WITH THE FLOORING SLAB AND DEAD PLANS ALONG WITH THE FOOD LION CONSTRUCTION MANAGER PRIOR TO COMMENCING WORK.
 19. INSTALL NEW QUARRY, CERAMIC OR PORCELAIN TILE AT A 90° ANGLE TO THE WALL, UNLESS OTHERWISE NOTED; LEVEL WITH FINISHED FLOOR. MATCH EXISTING.
 20. RESTROOMS, MEAT PREP, MEAT COOLER, MEAT STORAGE, DELI/BAKERY PREP, DELI/BAKERY COOLER AND DELI/BAKERY STORAGE SHALL HAVE EPoxy GROUT CONFORMING TO T5A ARIH HT, ANSI A118.3; FOR ANY REPAIR/REMODEL WORK.
 21. FLOOR TILE MANUFACTURER SHALL PROVIDE A LETTER CERTIFYING ALL TILES ARE SLIP RESISTANT IN ACCORDANCE WITH CABO/ANSI 117.1-2009 SECTION 302.

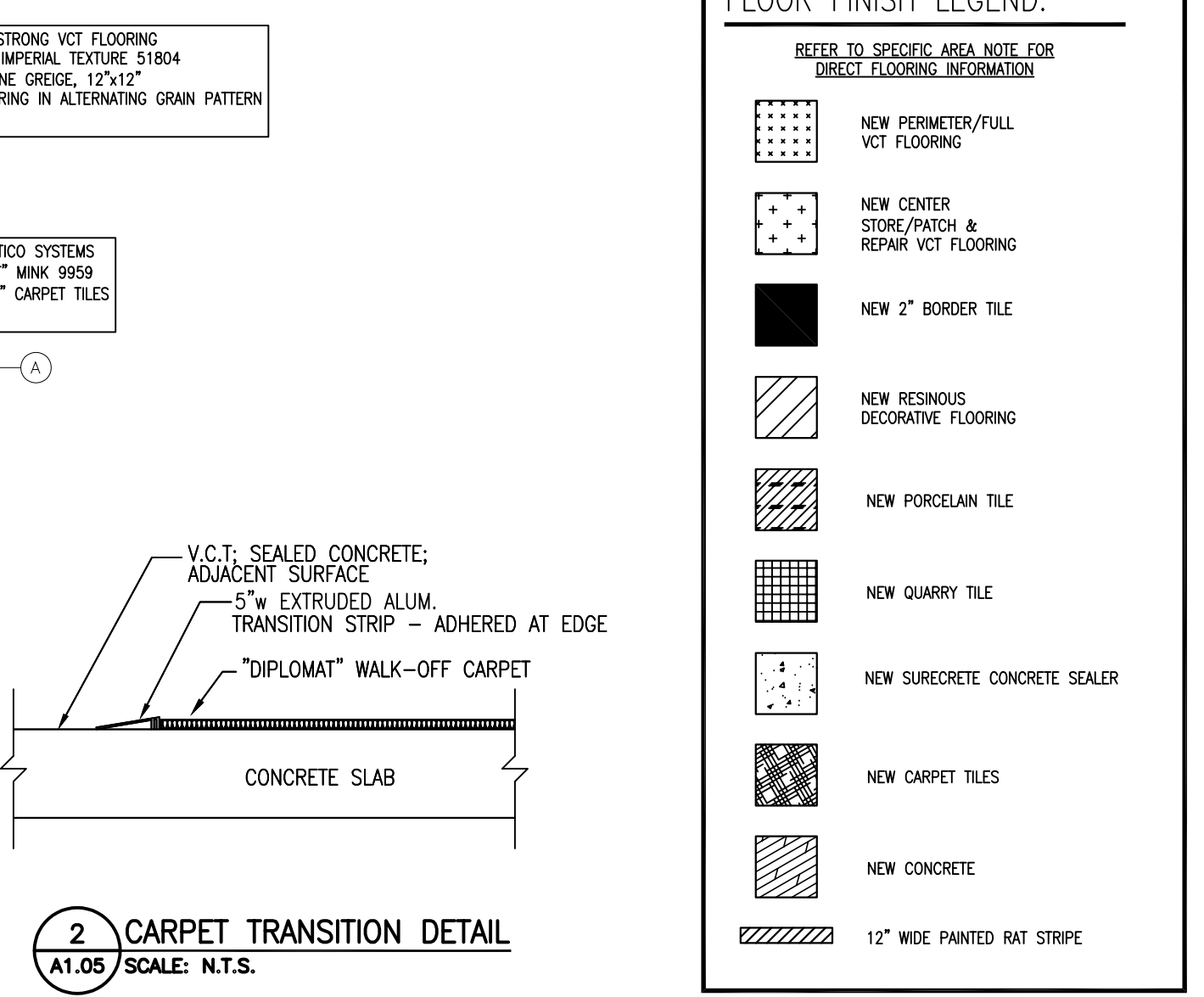

1 FLOOR FINISH PLAN
 A1.05 SCALE: 3/32" = 1'-0"

FILE NAME: E:\1\005\2009 - FOOD LION #1657-GREENVILLE.NC\1657A1.05_A.DWG Aug 24, 2022 - 12:44pm