

PROFESSIONAL'S SEAL:

**PRELIMINARY - NOT FOR CONSTRUCTION**

CORPORATE SEAL:

**FOOD LION**  
 APPROVAL  
 APPROVED  
 APPROVED AS NOTED  
 NOT APPROVED  
 DATE \_\_\_\_\_  
 BY \_\_\_\_\_

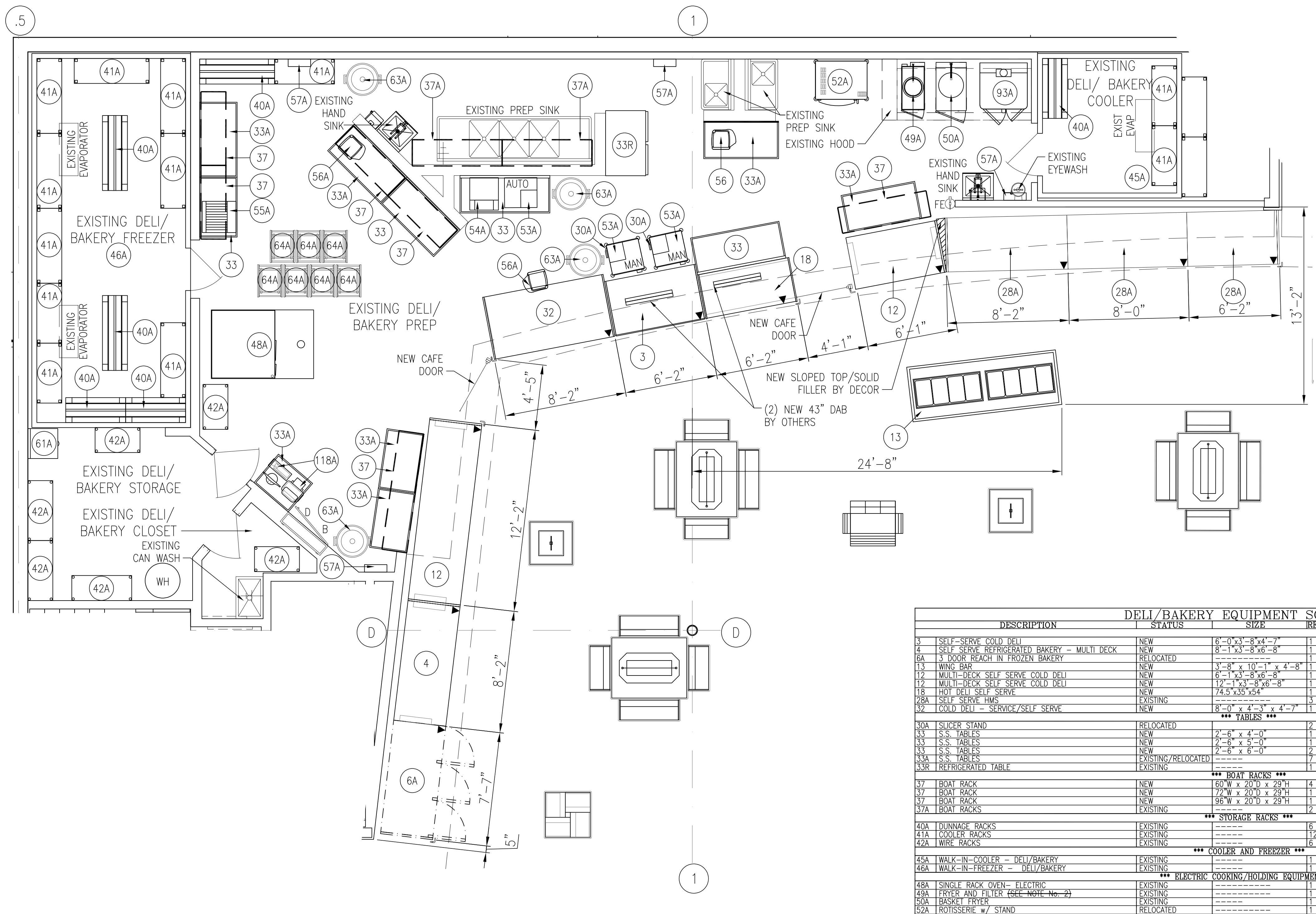

1 DELI/BAKERY FIXTURE PLAN  
 A4.01 1/4" = 1'-0"

DELI/BAKERY EQUIPMENT SCHEDULE						
DESCRIPTION	STATUS	SIZE	REQD	MODEL	SUPPLIER/MANUFACTURER	
3 SELF-SERVE COLD DELI	NEW	6'-0"x3'-8"x4'-7"	1	Q4-SS	HUSSMANN	
4 SELF-SERVE REFRIGERATED BAKERY - MULTI DECK	NEW	8'-1"x3'-8"x6'-8"	1	D5X	HUSSMANN	
6A 3 DOOR REACH IN FROZER BAKERY	RELOCATED	8'-1"x3'-8"x6'-8"	1		HUSSMANN	
13 WING BAR	NEW	3'-8" x 10'-1" x 4'-8"	1	MHC1204M-FF	ATLANTIC HOT FOOD BARS	
12 MULTI-DECK SELF-SERVE COLD DELI	NEW	6'-1"x3'-8"x6'-8"	1	D5X	HUSSMANN	
12 MULTI-DECK SELF-SERVE COLD DELI	NEW	12'-1"x3'-8"x6'-8"	1	D5X	HUSSMANN	
18 HOT DELI SELF-SERVE	NEW	74.5"x35"x54"	1	WRGCL7235-EP-PCB	ATLANTIC FOOD BARS	
28A SELF-SERVE HWS	EXISTING	8'-0" x 4'-3" x 4'-7"	3		HUSSMANN	
32 COLD DELI - SERVICE/SELF-SERVE	NEW	8'-0" x 4'-3" x 4'-7"	1	VR3HV-D-8R	HUSSMANN	
*** TABLES ***						
30A SLICER STAND	RELOCATED	2'-6" x 4'-0"	2			
33 S.S. TABLES	NEW	2'-6" x 4'-0"	1			
33 S.S. TABLES	NEW	2'-6" x 5'-0"	2			
33 S.S. TABLES	NEW	2'-6" x 8'-0"	1			
33A S.S. TABLES	EXISTING/RELOCATED	2'-6" x 8'-0"	7			
33R REFRIGERATED TABLE	EXISTING		1			
*** BOAT RACKS ***						
37 BOAT RACK	NEW	60"W x 20"D x 29"H	4	MBR6000-2SH-FL	JOHN BOOS & COMPANY	
37 BOAT RACK	NEW	72"W x 20"D x 29"H	1	MBR7200-2SH-FL	JOHN BOOS & COMPANY	
37 BOAT RACK	NEW	96"W x 20"D x 29"H	1	MBR9620-2SH-CM-FL	JOHN BOOS & COMPANY	
37A BOAT RACKS	EXISTING		2			
*** STORAGE RACKS ***						
40A BINNAGE RACKS	EXISTING		6			
41A COOLER RACKS	EXISTING		12			
42A WIRE RACKS	EXISTING		6			
*** COOLER AND FREEZER ***						
45A WALK-IN-COOLER - DELI/BAKERY	EXISTING		1			
46A WALK-IN-FREEZER - DELI/BAKERY	EXISTING		1			
*** ELECTRIC COOKING/HOLDING EQUIPMENT ***						
48A SINGLE RACK OVEN - ELECTRIC	EXISTING		1			
49A FRYER AND FILTER (SEE NOTE No. 2)	EXISTING		1			
50A BASKET FRYER	EXISTING		1			
52A ROTISSERIE w/ STAND	RELOCATED		1			
93A CONVECTION OVEN	EXISTING		1			
*** ELECTRIC PREP EQUIPMENT ***						
53A SLICERS - 2 MANUAL, 1 AUTOMATIC	RELOCATED		3			
54A WRAPPING MACHINE	RELOCATED		1			
55A BREAD SLICER	RELOCATED		1			
56 SCALE w/ BUILT IN PRINTER	NEW	1'-3"x1'-5"x1'-6"	1	HTI/HWS-ES	HOBART	
56A SCALE	RELOCATED		2			
57A FLY TRAP (SEE NOTE No. 8)	EXISTING		4			
118A CAKE DECORATOR/PRINTER	EXISTING		1			
*** NON-ELECTRIC PREP EQUIPMENT ***						
61A DESK (WALL MOUNTED)	EXISTING		1			
63A TRASH CAN	EXISTING		4			
64A OVEN RACK (PLATTER CART)	EXISTING		7			

- DELI/BAKERY GENERAL NOTES**
- THE GENERAL CONTRACTOR IS RESPONSIBLE FOR COMPLIANCE WITH ALL HEALTH DEPARTMENT REQUIREMENTS.
  - ACCESSORIES FOR PRESSURE FRYER: A. HEAVY-DUTY BASTERS, B. FILTER HOSE.
  - PLUMBING CONTRACTOR IS TO INSTALL ALL SINKS AND EYE WASH UNITS.
  - THE MECHANICAL CONTRACTOR SHALL PROVIDE AND INSTALL MECHANICAL EQUIPMENT FOR THE DELI/BAKERY AS REQUIRED.
  - THE EQUIPMENT LISTED IN THE DELI/BAKERY EQUIPMENT SCHEDULE IS SUPPLIED BY FOOD LION, AND IS SET IN PLACE BY FOOD LION'S REFRIGERATION CONTRACTOR. THE GENERAL CONTRACTOR IS RESPONSIBLE FOR ALL ELECTRICAL, PLUMBING, AND H.V.A.C. EQUIPMENT CONNECTIONS.
  - THE GENERAL CONTRACTOR SHALL INSTALL THE BOAT RACKS THAT ARE PROVIDED BY FOOD LION. THE GENERAL CONTRACTOR SHALL COORDINATE THE EXACT LOCATION WITH A FOOD LION CONSTRUCTION SUPERVISOR.
  - THE PAPER TOWEL HOLDERS ARE SUPPLIED BY FOOD LION AND INSTALLED BY THE GENERAL CONTRACTOR. INSTALL THE PAPER TOWEL HOLDERS AT 5'-0" ABOVE FINISHED FLOOR.
  - MOUNT FLY TRAPS AT 5'-0" ABOVE FINISHED FLOOR IN DELI/BAKERY AND PREPARE PREP.
  - THE ADDITIONAL 31-DRAWER DISPLAY TABLES, MODEL No. 1010-1800-1, SHALL BE SUPPLIED IF THE STORE HAS A REFRIGERATED FLOOR DISPLAY.
  - THE GENERAL CONTRACTOR SHALL SUPPLY AND INSTALL TWO BROOM HANGERS AND THREE MOP HANGERS IN THE DELI. ALSO SUPPLY AND INSTALL A 12"x36" SHELF IN THE CLOSET AT 6'-0" ABOVE FINISHED FLOOR. COORDINATE LOCATION OF THE SHELF AND HANGERS WITH FOOD LION IF NOT ALREADY INSTALLED.
  - THE GENERAL CONTRACTOR SHALL PROVIDE AND INSTALL A SYSTEM (3 ROWS OF 5 CLIPBOARD EACH) FOR HANGING FIFTEEN CLIPBOARDS ABOVE THE DESK IN THE DELI IF NOT ALREADY INSTALLED.

REVISIONS  
 NO DATE REMARKS

FILE NAME: E:\1005\22069 - FOOD LION #1657 - GREENVILLE, NC\DWGSS\RELEASE A\1657A4.01\_00.DWG Jun 09, 2022 - 4:41pm