

4B FLOOR PLAN - MAIN LEVEL
SCALE: 3/32" = 1'-0"

NOTE:
INSTALL NEW DECOR AND AISLE MARKERS AS INDICATED ON DECOR DRAWINGS.

DOOR SCHEDULE

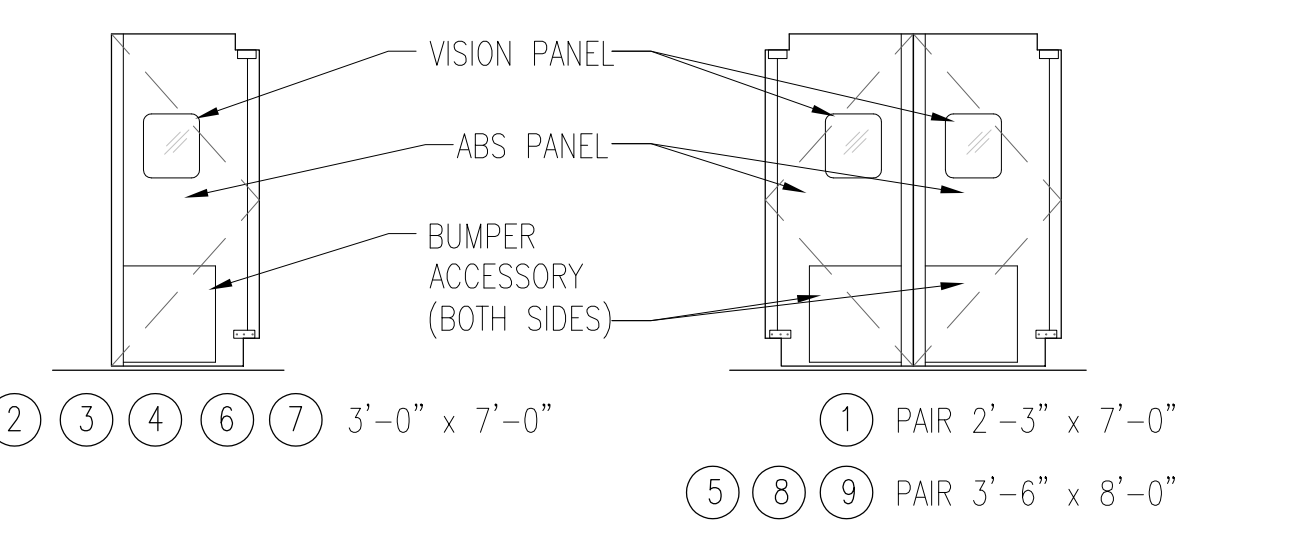

- GENERAL NOTES:
- INSTALL KROGER FURNISHED NEW DOUBLE ACTING INSULATED TRAFFIC DOORS IN EXISTING FRAME PER SPEC. SECT. 083100. RE-PAIN FRAME PER DECOR DRAWINGS. SEAL ALL JOINTS AROUND EDGE OF FRAME (BOTH SIDES).
 - G.C. TO FIELD VERIFY DOOR OPENING SIZE FOR SHOP DRAWINGS PRIOR TO ORDERING BY KROGER P.M.

PLAN NOTES

- NEW SHELVING/END CAPS TO BE FURNISHED BY KROGER AND INSTALLED BY GENERAL CONTRACTOR (G.C.) PER SPEC. SECT. 114113. G.C. TO FURNISH POWER AS REQUIRED PER ELECTRICAL DRAWINGS.
- NEW FIXTURE TO BE FURNISHED BY KROGER AND INSTALLED BY G.C. PER SPEC. SECT. 114113. NO ELECTRICAL OR PLUMBING WORK REQUIRED.
- NEW FIXTURE TO BE FURNISHED BY KROGER AND INSTALLED BY G.C. PER SPEC. SECT. 114113. SEE PLUMBING AND/OR ELECTRICAL FOR MORE INFORMATION.
- NEW FIXTURE TO BE FURNISHED BY KROGER AND INSTALLED BY REFRIGERATION CONTRACTOR (R.C.) PER SPEC. SECT. 114122. SEE PLUMBING, ELECTRICAL AND/OR REFRIGERATION DRAWINGS FOR MORE INFORMATION. G.C. TO COORDINATE.
- RELOCATED SHELVING/END CAPS TO BE INSTALLED BY GENERAL CONTRACTOR (G.C.) PER SPEC. SECT. 114113. G.C. TO FURNISH POWER AS REQUIRED PER ELECTRICAL DRAWINGS.
- RELOCATED FIXTURE TO BE INSTALLED BY G.C. PER SPEC. SECT. 114113. NO ELECTRICAL OR PLUMBING WORK REQUIRED.
- RELOCATED FIXTURE TO BE INSTALLED BY R.C. PER SPEC. SECT. 114122. SEE PLUMBING, ELECTRICAL AND/OR REFRIGERATION DRAWINGS FOR MORE INFORMATION. G.C. TO COORDINATE.
- FURNISH & INSTALL REFRIGERATED CASE CLOSURES PER GSD-2 & SPEC. SECT. 114113.
- FURNISH & INSTALL NEW STAINLESS STEEL CASE CORNER GUARDS PER ASD-160 & SPEC. SECT. 114113-00.
- FURNISH & INSTALL NEW STAINLESS STEEL GLASS DOOR END CASE CORNER GUARDS PER ASD-160A & SPEC. SECT. 114113-00.
- FURNISH & INSTALL NEW STAINLESS STEEL REMOVABLE POST CORNER GUARD PER ASD-19 & SPEC. SECT. 114113-00.
- FURNISH & INSTALL NEW PLASTIC LAMINATE COVERED 3/4" PLYWOOD FILLER AS REQUIRED PER SPEC. SECT. 114113. FURNISH & INSTALL NEW VINYL BASE TO SURFACES EXPOSED TO SALES FLOOR. SIDE PER ASD-510 MATCHING SALES FLOOR. PROVIDE SHOP DRAWINGS TO KROGER P.M. FOR APPROVAL PRIOR TO FABRICATION.
- INSTALL KROGER FURNISHED DOCK LIGHT ON EXISTING MOUNTING BRACKET. SEE ELECTRICAL DRAWINGS.
- RELOCATE/FURNISH & INSTALL NEW CASE TOP HOSE BIB BRACKET PER GSD-38 & SPEC. SECT. 114113 WHERE BIB LOCATION IS INDICATED ON PLUMBING DRAWINGS.

GENERAL NOTES

- INSTALL NEW "ARTISAN" DECOR & DECOR LIGHTING. SEE DECOR DRAWINGS FOR MORE INFORMATION.
- SEE THIS SHEET FOR DOOR SCHEDULE.
- INSTALL SOLID FRY WOOD BLOCKING IN ALL WALL LOCATIONS WHERE WALL MOUNTED FIXTURES, EQUIPMENT AND/OR ACCESSORIES ARE TO BE LOCATED. INCLUDING BUT NOT EXCLUSIVE TO:
 FLY TRAPPERS AND SCONES
 FIRE EXTINGUISHERS
 IDP RACKS
 WALL DESKS & MARKER BOARDS
 MILLWORK
- INSTALL KROGER FURNISHED FIRE EXTINGUISHERS. COORDINATE LOCATIONS WITH BUILDING OFFICIAL AND FIRE OFFICIAL DURING WALK-THRU PRIOR TO COMPLETION.
- SEE AS SHEET SERIES FOR ASD & GSD DETAILS.
- FURNISH NEW BUILDING PLAN STORAGE BOX PER GSD-24. LOCATE AS DIRECTED BY KROGER P.M.
- PATCH AND REPAIR ALL EXISTING WALLS RECEIVING NEW DECOR FINISHES. FINISHES TO INCLUDE PAINT, WALLPAPER, MARBLE, ETC. INTENT IS TO PROVIDE SMOOTH EVEN FINISH. ALL SURFACES ON SALES FLOOR TO RECEIVE NEW FINISH. SEE DECOR DRAWINGS AND A1.6.
- CLEAN ALL HVAC GRILLES & REMOVE DUST FROM TOPS OF HVAC DUCTS IN AREAS OF STORE EXPOSED TO PUBLIC (SALES FLOOR, VESTIBULE, ETC.)

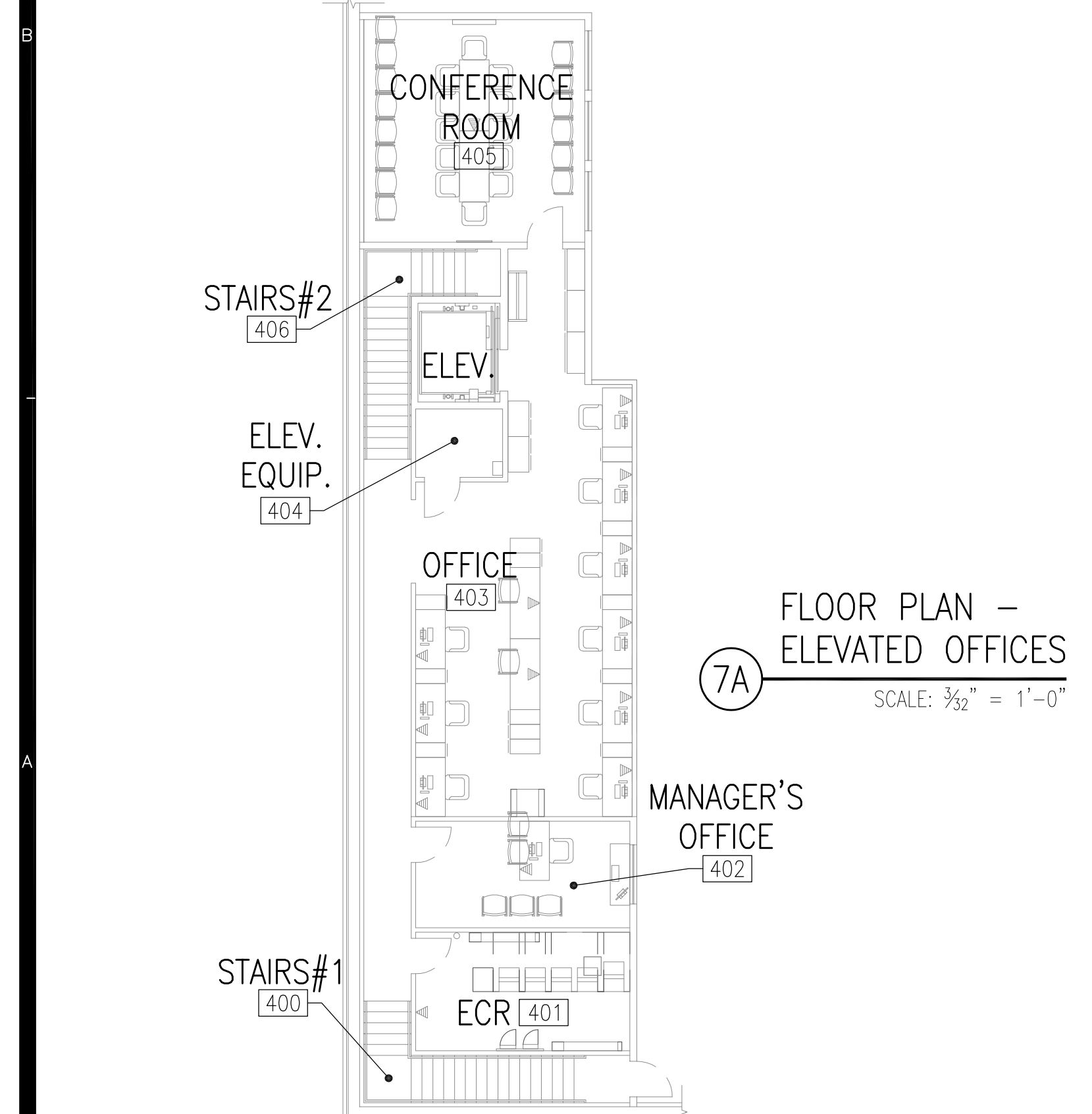

7A FLOOR PLAN - ELEVATED OFFICES
SCALE: 3/32" = 1'-0"

MANAGER'S OFFICE